

The next generation of cable suspension products designed for the fast suspension of pipework, ductwork, HVAC systems and modules including multi-tier installations.

FEATURES / BENEFITS

- **Quick** – up to 6 times faster than traditional suspension systems
- **Safe** – can be pre-installed to channel using pre-fitted washer/nut or using retention clip reducing time working at height
- **Easy** – integral ergonomically designed release button allows for simple adjustment
- **Secure** – button acts as a locking screw and indicator clearly highlights the cable is locked in position for ultimate security
- **Versatile** – variety of foot attachments available to suit applications
- **Strong** – highest load rating capability to date up to 550 lbs with 5:1 SWL

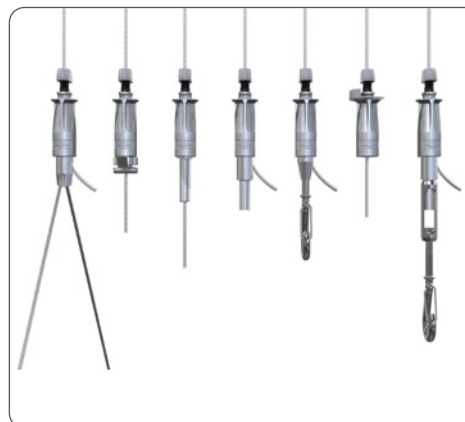

INSTALLATION & ADJUSTMENT

1.

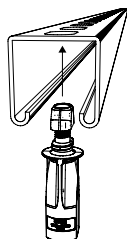

2.

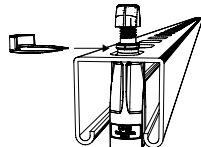

3.

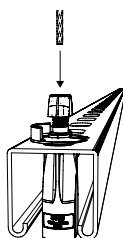

4.

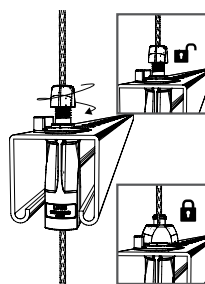

Adjustment

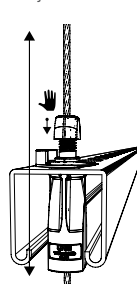

Multi-tiered

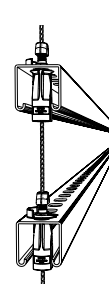

SPECIFICATION

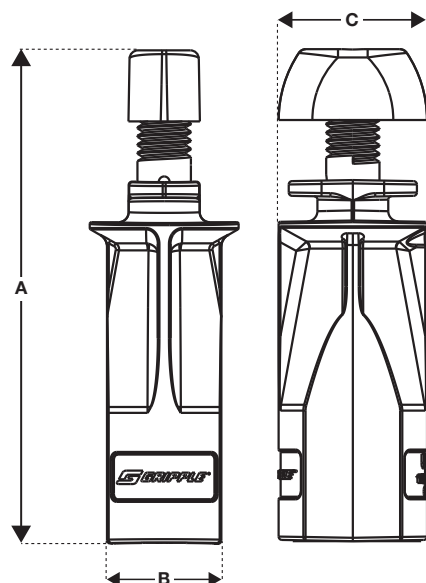

No. 2	Dimension	A	B	C
	Inches	2.14	0.66	0.78

No. 3	Dimension	A	B	C
	Inches	2.85	0.66	0.86

No. 4	Dimension	A	B	C
	Inches	4.50*	0.86	1.18

* Includes 1" long 1/2" thread

Maximum off axis suspension = 15° (Unless otherwise specified by Gripple Technical Services).

AVAILABLE END FIXINGS

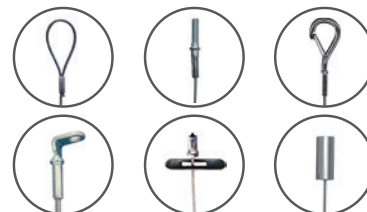

For more options on available end fixings please contact us or visit www.gripple.com

SUBMITTAL INFORMATION

Load Rating:

No.2 - 120 lbs, No.3 - 240 lbs,
No.4 - 550 lbs at 5:1 safety factor

Material:

Housing - Type ZA2 Zinc
Carriage - Acetal Copolymer
Wedge - Sintered steel hardened to
min. 56 Rockwell C
Button - Acetal Copolymer

Approvals: CSA & UL 1598 & UL 2239

NOT suitable for use in chlorinated/swimming
pool environments.

UniGrip - Standard



SPECIFICATION

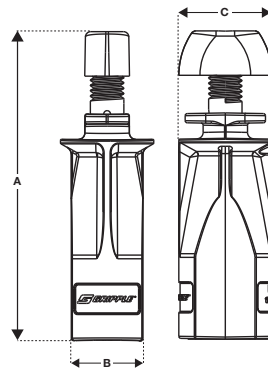

No. 2	Dimension	A	B	C
	Inches	2.14	0.66	0.78

No. 3	Dimension	A	B	C
	Inches	2.85	0.66	0.86

Foot Material	End Cap – PP (Polypropylene)
---------------	------------------------------

Clip Material	Retention Clip – PP (Polypropylene)
---------------	-------------------------------------

Maximum off axis suspension = 15° (Unless otherwise specified by Gripple Technical Services).

OVERVIEW

- Supplied with retention clip for pre-fabrication applications
- Designed for non-mechanical fixing through brackets
- Central cable exit

INSTALLATION

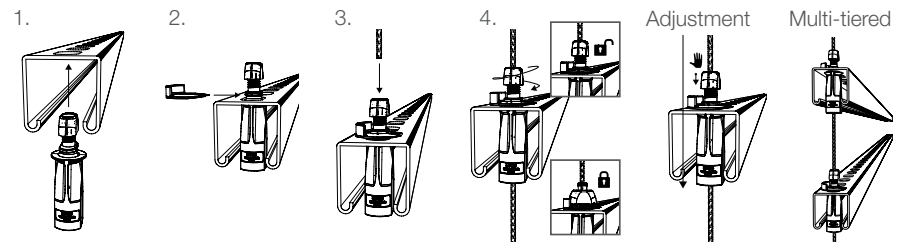

UniGrip - QT



SPECIFICATION

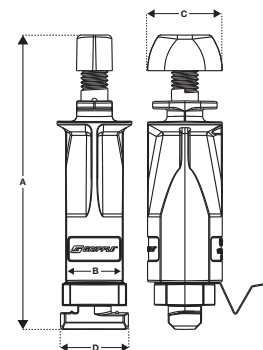

No. 2	Dimension	A	B	C	D
	Inches	2.71	0.66	0.78	0.78

No. 3	Dimension	A	B	C	D
	Inches	3.40	0.66	0.86	0.78

Foot Material	Twist Fit Adapter – Zinc Alloy (EN12844 ZP2) Spring Clip – Stainless Spring Steel BS5770 301 S21
---------------	---

Maximum off axis suspension = 15° (Unless otherwise specified by Gripple Technical Services).

OVERVIEW

- Designed for use with Gripple Universal Brackets
- Fast, simple quarter turn installation, no mechanical fix required
- Features safety clip for ultimate security
- Central cable exit

INSTALLATION

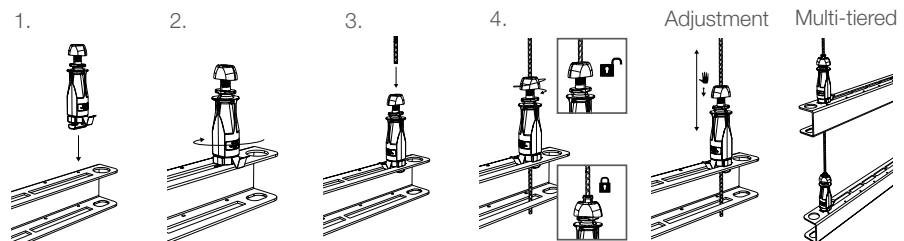

UniGrip - Central Exit



SPECIFICATION

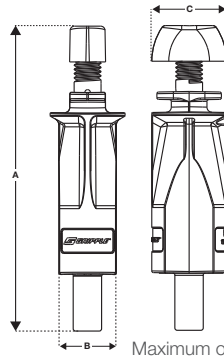

No. 2	Dimension	A	B	C
	Inches	3.16	0.66	0.78
No. 3	Dimension	A	B	C
	Inches	3.89	0.66	0.86
No. 4	Dimension	A	B	C
	Inches	4.50	0.86	1.18
Foot Material	Thread – Mild Steel (Type EN1A) - Bright Zinc Plated			

Maximum off axis suspension = 15° (Unless otherwise specified by Gripple Technical Services).

** Maximum torque value to be applied, No. 2 and No. 3 = 4 lb.-ft (5Nm), No. 4 = 18lb.-ft (25Nm)

OVERVIEW

- 1" male thread for mechanical fixing
- Supplied with either a square washer and channel nut or hex nut
- Thread sizes - 3/8" (UniGrip #2), 3/8" (UniGrip #3) and 1/2" (UniGrip #4)
- Central cable exit
- Ideal for use with Clevis Hanger

INSTALLATION

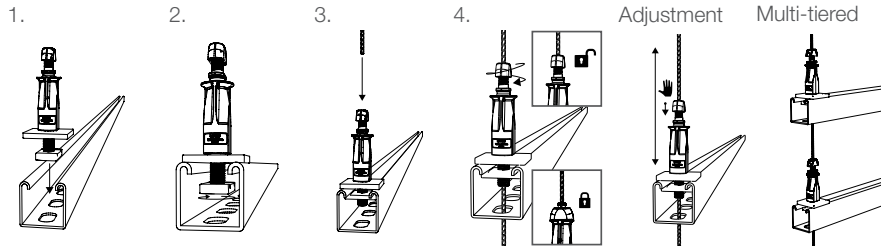

UniGrip - Side Exit

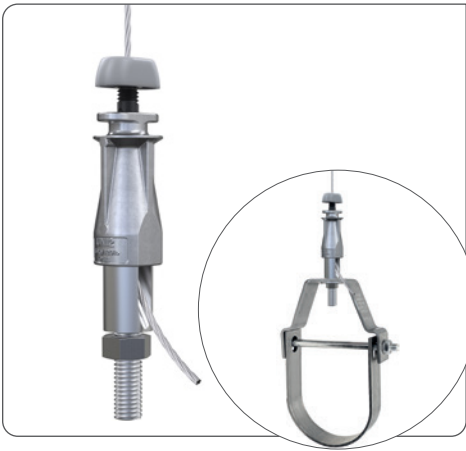

SPECIFICATION

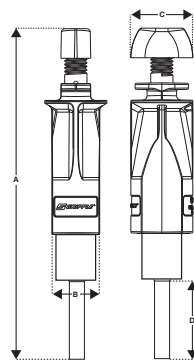

No. 2	Dimension	A	B	C	D
	Inches	3.85	0.66	0.78	0.98
No. 3	Dimension	A	B	C	D
	Inches	4.56	0.66	0.86	1.37
Foot Material	Thread – Mild Steel (Type EN1A) - Bright Zinc Plated				

Maximum off axis suspension = 15° (Unless otherwise specified by Gripple Technical Services).

Maximum torque value to be applied, No. 2 and No. 3 = 4 lb.-ft (5Nm), No. 4 = 18lb.-ft (25Nm)

OVERVIEW

- Designed for applications in which cable cannot exit centrally (avoiding clashes with services)
- Supplied with a hex nut
- Side cable exit
- Thread sizes - 3/8" (UniGrip #2), 3/8" (UniGrip #3)
- Ideal for use with Clevis Hanger

INSTALLATION

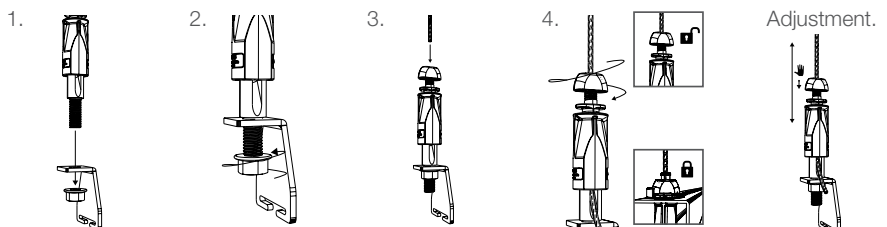

UniGrip - Calibra



SPECIFICATION

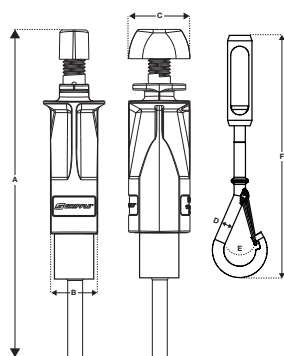

No.2	Dimension	A	B	C	D	E	F
	Inches	2.14	0.66	0.78	0.24	0.31	5.27

Foot Material	Thread – Mild Steel (Type EN1A) - Bright Zinc Plated Turnbuckle – Mild Steel (Type EN1A) - Bright Zinc Plated Crimped Pin – Mild Steel (Type EN1A) - Bright Zinc Plated Snap Hook – Mild Steel (Type EN1A) - Bright Zinc Plated
---------------	--

Maximum off axis suspension = 15° (Unless otherwise specified by Gripple Technical Services).

OVERVIEW

- Allows for adjustment of building services under load
- 1.37" of adjustment using integral pillar and M8 thread
- Side cable exit

INSTALLATION

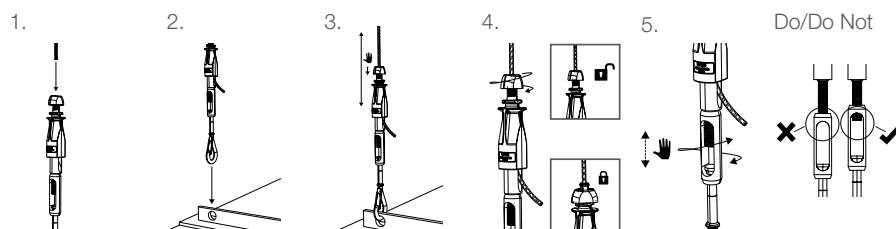

UniGrip - Hook



SPECIFICATION

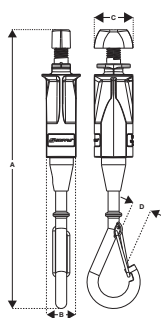

No. 2	Dimension	A	B	C	D
	Inches	5.53	0.66	0.78	Ø 1.19

Foot Material	Hook Adaptor – Mild Steel (Type EN1A) - Bright Zinc Plated
---------------	--

Maximum off axis suspension = 15° (Unless otherwise specified by Gripple Technical Services).

OVERVIEW

- Self closing latch for security
- Ideal for fast attachment to heating/cooling panels and light fittings
- Side cable exit

INSTALLATION

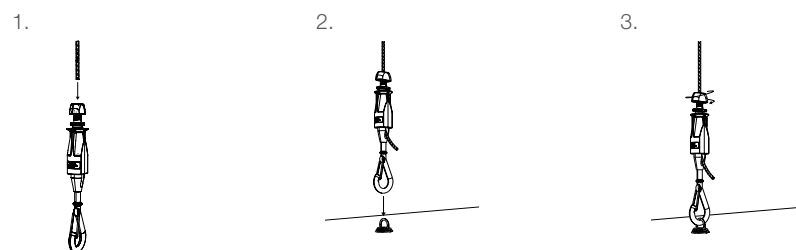

UniGrip - Y-Fit



SPECIFICATION

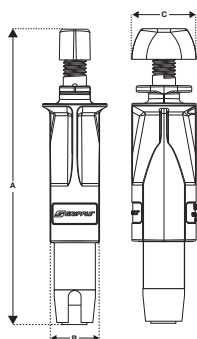

No. 2	Dimension	A	B	C
	Inches	3.14	0.66	0.78

No. 3	Dimension	A	B	C
	Inches	3.77	0.66	0.86

Foot Material	Y-Fit Adapter – Mild Steel (Type EN1A) - Bright Zinc Plated Grub Screw – Mild Steel (Type EN1A) - Bright Zinc Plated
---------------	---

Maximum off axis suspension = 15° (Unless otherwise specified by Gripple Technical Services).

OVERVIEW

- Dual fixing points for balance
- 6", 12" and 18" leg lengths as standard
- Grub screw can be adjusted with a 5/32" hex key in order to adjust the legs
- Legs available with a variety of cable end fixings eg. Toggle, Snap Hook etc.
- Side cable exit

INSTALLATION

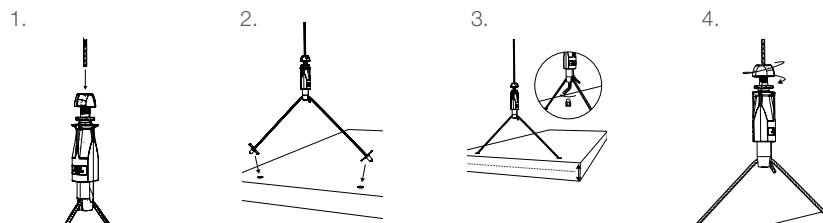

UniGrip - Cable Basket Adapter



SPECIFICATION

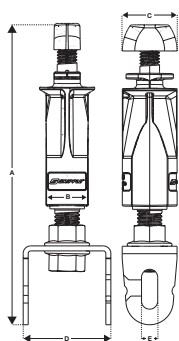

No. 2	Dimension	A	B	C	D	E
	Inches	3.16	0.66	0.78	1.37	0.25

Foot Material	Thread – Mild Steel (Type EN1A) - Bright Zinc Plated Cable Basket Adapter – Steel S450GD
---------------	---

Maximum off axis suspension = 15° (Unless otherwise specified by Gripple Technical Services).

OVERVIEW

- Designed for fast suspension of cable baskets up to 1/4"
- Eliminates requirement for channel bearers
- Central cable exit

INSTALLATION

